

HDT HUNTER WOLF™

The highly maneuverable, endlessly adaptable unmanned vehicle



The HDT Hunter WOLF is purpose-designed to support light infantry. Compact and powerful, it carries 2,200 pounds and it goes where manned vehicles cannot – traversing narrow trails, steep slopes and dense jungles. An extremely rugged 6x6 robot, the WOLF has the traction and pivot-turn capability of a tracked vehicle, but it runs on easy-to-maintain Michelin non-pneumatic Tweels®.

The hybrid diesel / electric drivetrain has enough battery power for the WOLF to silently carry a full payload more than 12 kilometers offroad. By recharging on the move with its internal diesel / JP-8 engine, it can carry a full payload more than 200 miles offroad, using only internal fuel. Its powerful engine means the WOLF is never forced to stop for recharging and is always 100% mission-ready.

The Hunter WOLF's powerful drivetrain also outputs 15kW of electrical power for payloads. Some customers consider it to be a self-propelled 15kW generator, which also fits in a V-22 and carries 2,200 pounds.

Easily configured for different missions, the Hunter WOLF can be fitted with a wide variety of autonomy kits, using its non-proprietary interface to the open-source Robotic Operating System (ROS). Each WOLF also has hardpoints on every surface to attach heavy payloads.

HDT HUNTER WOLF™

The highly maneuverable, endlessly adaptable unmanned vehicle

KEY FEATURES

- Rugged design, developed for demanding conditions
- Carries over 1,000 kg (2,200 lbs) off-road more than 300 km (200 miles) using internal JP-8 or diesel. Optional long-range fuel tank increase range to over 1,000 km (600 miles)
- Exports up to:
 - 2kW at 120/230VAC
 - 5kW at 28VDC
 - 15kW at 100VDC
 - 15kW at 208V/3Ph and 240V/1ph using inverter kit
- Robotic Operating System (ROS) interface for third-party controllers
- Hybrid / electric powertrain with silent operation mode
- Flat-towable at up to 100 kph (62 mph) with standard military towbar
- Minimal requirements for field maintenance, due to its rugged construction, low engine duty cycle and sealed drivetrain components.



MODULAR MISSION PAYLOADS



MOBILE WATER PURIFICATION

The mobile water purification kit produces 240 liters per hour (60 gph) from fresh water sources or 120 liters per hour (30 gph) from saltwater sources.



INTELLIGENCE SURVEILLANCE RECONNAISSANCE

From drone operations to electronic attack, the Hunter WOLF's silent operations, extensive power offload and expandable payload make it the ideal ISR platform.



REMOTE WEAPON STATION

Remote weapon stations up to a 30 mm auto-cannon from several leading manufacturers have been integrated onto the WOLF and live-fire tested.



PINTLE M2 AND ARMOR

Tailored to meet customer needs, the baseline Hunter WOLF is configured to accept armor and multiple weapon platforms.



CASEVAC

The Hunter WOLF can hold two litters on deck and can be rigged to side-carry an additional two. It can carry and power a mission kit for Prolonged Field Care.



TRAIL CLEARANCE

When outfitted with its flail, the Hunter WOLF is able to conduct unmanned mine clearance. Equipped with cutter blades, it can also clear vegetation to clear landing zones, trails and fire breaks.



BREACHING KIT

Battering ram with grappling hooks to move obstacles or gain access to structures in seconds.



CBRNE KIT

Customizable to users' needs, the Hunter WOLF has been integrated with a suite of chemical, biological, radiological, nuclear and explosive detection, as well as pharmaceutical-based agents detection.



AUTONOMY KIT

The Hunter WOLF conforms to open standards, allowing integration of third-party autonomy systems. HDT's own autonomy kit provides waypoint follow with robust obstacle detection and avoidance.



LIGHTWEIGHT EXPEDITIONARY BRIDGE

Utilizing HDT's AirBeam® technology, the lightweight expeditionary bridge can be transported on the Hunter WOLF and deployed in less than 30 minutes to bridge gaps up to 36' wide.



FOB SUPPORT / SELF-PROPELLED GENERATOR

Hunter WOLF provides complete capabilities for a mobile FOB — deploy from V-22, carry 1000 kg of equipment and provide 15kW power (mission kits for 15kW 230 VAC and 15kW 208 VAC 3-phase).



LOW GROUND PRESSURE KIT

The low ground pressure kit gives the Hunter WOLF excellent ground holding capabilities and efficient mobility through extreme terrains. This kit is easy and quick to install.

HDT HUNTER WOLF™

*The highly maneuverable, endlessly adaptable
unmanned vehicle*



SPECIFICATIONS

Payload	2,200 lbs	1,000 kg
----------------	-----------	----------

Range, unrefueled	200 miles	300 km
--------------------------	-----------	--------

Range, silent run	7.5 miles	12 km
--------------------------	-----------	-------

Transportability	UH-60 (1 sling-load) CH-47 (3 internal) V-22 (1 internal) C-130 (8 internal)	
-------------------------	---	--

Tow speed, using standard military tow bar (unloaded)	62 mph	100 kph
--	--------	---------

Power export	2KW @ 120VAC 5KW @ 28VDC 15KW @ 100VDC	
---------------------	--	--

Dimintions (L x W x H)

With Deck Extension	90" x 55" x 46"	230 x 140 x 117 cm
---------------------	-----------------	--------------------

Without Deck Extension	60" x 53" x 46"	152 x 134.6 x 117 cm
------------------------	-----------------	----------------------

Curb weight	3,600 lbs	1,600 kg
--------------------	-----------	----------

Slopes	60%/30° climb and descend 40%/22° side slope	
---------------	---	--

Water fording	24 in	60 cm
----------------------	-------	-------

Speed	10 mph	16 kph
--------------	--------	--------



Single Hand Controller

0.5 lbs (0.2 kg)

1,960 ft (600 m) range

24 hr battery life

Integral E-stop

>100'

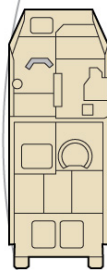

Stryker

>50'



HMMWV

38'

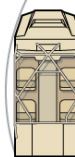

ISV

9'



WOLF

HDT Expeditionary Systems, Inc.

30500 Aurora Road, Suite 100, Solon, OH 44139 USA

P 800.969.8527 / 216.HDT.6111 / sales@hdtglobal.com

NON-EXPORT CONTROLLED INFORMATION

Revision 10 09-23 01-02-01-0566