



# RIGID WALL SHELTER SYSTEMS







# THE STANDARD IN RIGID WALL SHELTERS

Berg™ shelters from HDT Global are robust, flexible and built for environmental extremes. Available in expanding wall or non-expandable variants, Berg rigid wall shelters are ISO 1496-1-, vehicle mounted-, or 463L aircraft-certified load compliant, making transport simple via standard methods. ISO variant shelters meet nine-high cargo ship stacking and CSC requirements, allowing for standard commercial cargo ship transport. With fully-configurable power and network options, Berg shelters are easily integrated into C5ISR command center infrastructure, or configured as kitchens, showers, latrines, billets, or medical facilities. Arctic options are available. Our Berg shelter technology includes such advanced features as 150KHz – 10GHz EMI shielding, bale bar for ease of PLS vehicle transport and CBRN / ColPro protection.





PRODUCT MANAGER  
FORCE SUSTAINMENT SYSTEMS  
PORT ENVIRONMENTAL  
CAMP INTEGRATION LAB





# E2S2-20

Our flagship 20-foot ISO expanding shelter is available with single- or double-expanding side walls that deploy in as little as 10 minutes and require no additional support. Designed for flexible deployment scenarios, the E2S2-20 can be complexed, stacked and complexed or mounted on a military trailer or vehicle. With an R-value of R-11 for E2S2, E2S2E, and VE2S2 and R-10.5 for B2E2S2, the E2S2-20 is built for energy-efficiency.

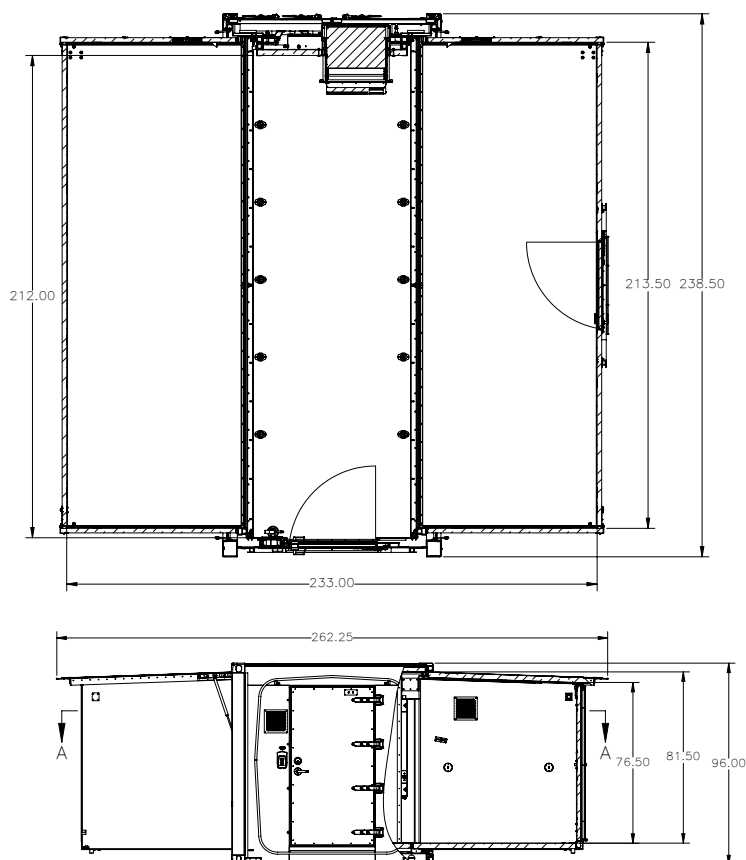

## KEY FEATURES

- Includes full power distribution, overhead lighting and an integrated ECU
- 60-amp standard, or optional 100-amp power distribution
- Optional 150KHz – 10GHz EMI shielding
- Optional bale bar for ease of transport
- Meets CSC shipping requirements and is stackable nine-high for transport or storage

## Measurements

Internal Dimensions	
Extended Width	233" / 592 cm
Extended Length	213.5" / 542.3 cm
Main Width	70.25" / 178.44 cm
Main Length	212" / 538.5 cm
Internal Height	
Main Shelter	81.5" / 207 cm
Expanding Side	76.5" / 194.3 cm
External Shipping	
238.5" x 96" x 96"	
606 x 244 x 244 cm	



# E2S2-10

BICON size 10-foot ISO shelter has the same options as our E2S2-20, but in a 10-foot footprint. Available with single- or double-expanding sides, the E2S2-10 can be deployed in as little as 10 minutes with no additional support required for the sidewalls. Designed for flexible deployment scenarios, the E2S2-10 can be complexed or mounted on a military trailer or vehicle. With an R-value of R-11.5, the E2S2-10 is built for energy-efficiency.

## KEY FEATURES

- Includes full power distribution, overhead lighting and an integrated ECU
- 60-amp standard, or optional 100-amp power distribution
- Meets CSC shipping requirements and is stackable nine-high for transport or storage

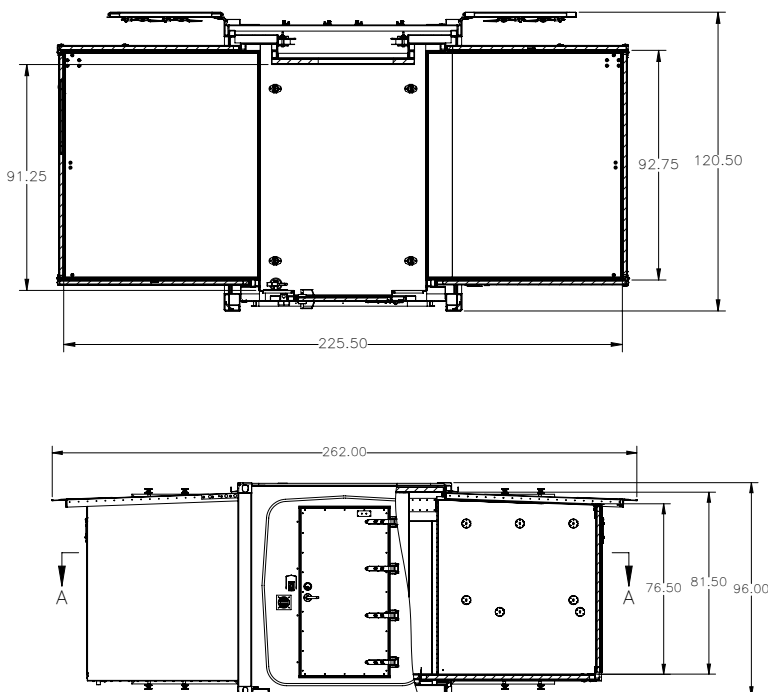

## Measurements

### Internal Dimensions

Extended Width	225.5" / 572.8 cm
Extended Length	92.75" / 235.6 cm
Main Width	66.75" / 169.54 cm
Main Length	91.25" / 231.8 cm

### Internal Height

Main Shelter	81.5" / 207 cm
Expanding Side	76.5" / 194.3 cm

### External Shipping

177.8" x 96" x 96"
299 x 244 x 244 cm



# LP2

The LP is a 463L pallet-certified shelter configuration and is available as a single- or double-wall expanding shelter that can be deployed in as little as 10 minutes with no additional support required for the sidewalls. Designed for flexible deployment, the LP can be complexed with other shelters. With an R-value of R-11, the LP is built for energy efficiency.

## KEY FEATURES

- Includes full power distribution, overhead lighting and an integrated ECU
- 60-amp standard, or optional 100-amp power distribution
- 463L pallet-certified for aircraft transport
- C-130, C-17, and C-5 Aircraft certified cargo

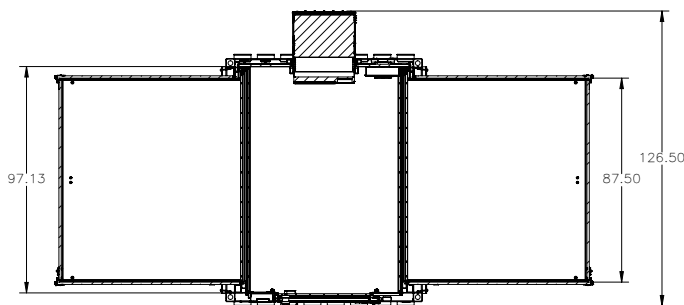
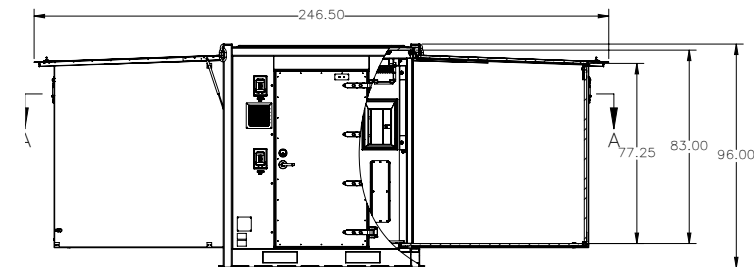

## Measurements

### Internal Dimensions

Extended Width 246.5" / 626.11 cm

Extended Length 87.5" / 222.25 cm

Main Width 63.5" / 161.29 cm

Main Length 97.13" / 246.7 cm

### Internal Height

Main Shelter 83" / 210.8 cm

Expanding Side 77.25" / 196.2 cm

### External Shipping

104.5" x 84.5" x 96"  
265 x 214.6 x 244 cm





# JLTS

The Joint Light Tactical Shelter (JLTS) delivers a state-of-the-art mobile shelter solution, purpose-built for the Joint Light Tactical Vehicle (JLTV). Featuring lightweight yet robust composite walls, the JLTS is engineered for both durability and operational efficiency, with an expandable design that enhances adaptability across a wide range of mission scenarios.

The shelter's innovative roof system can be extended to create a spacious interior, allowing up to five personnel to comfortably stand and operate within the environment, ensuring optimal workflow during critical operations.

## KEY FEATURES

- 60-amp power distribution
- C-130 transportable while mounted on a JLTV
- Expandable roof structure
- No modification or specialty tools required for integration
- FDC/C2 Model designed for FDC Sections and Smaller mobile Command Post operations
- S-6 Server model designed to house tactical server sets and provide work space for crews

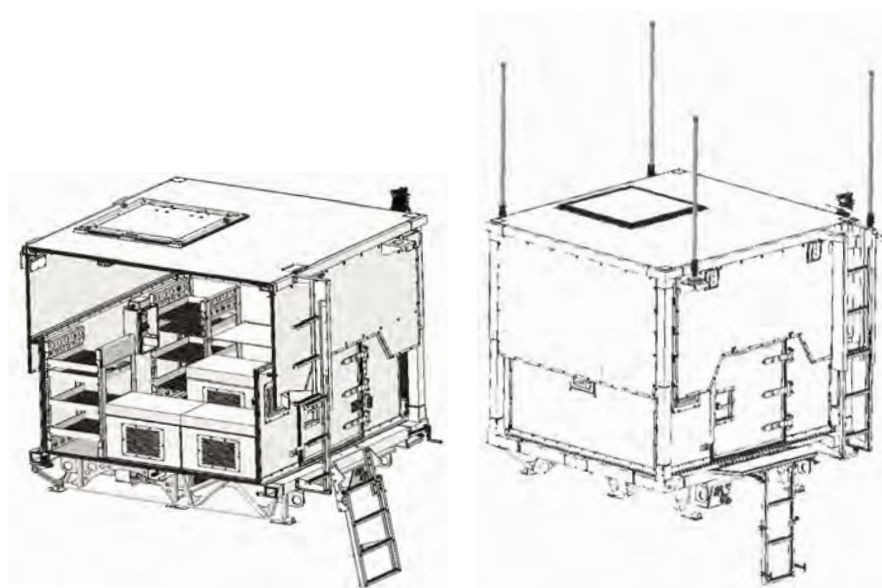

## Measurements

Internal Dimensions	
Stowed	72.25" x 82.75" x 45"
Stowed (cubic feet)	155ft <sup>3</sup>
Deployed	72.25" x 82.75" x 73.75"
Deployed (cubic feet)	255ft <sup>3</sup>
Exterior Dimensions	
Stowed	106.5" x 111.5" x 69"
Deployed	106.5" x 111.5" x 97.75"



# E2S2-N20

The Berg E2S2-N20 is a non-expanding shelter that is a high R-12, low weight composite construction ISO-compliant configuration. It is ideal for integrating up to 14,000 lbs. of equipment and, fully-loaded can be transported on a standard 9-ton 6x6 military vehicle. The shelter is easily configured into a personnel-occupied C5ISR command center or for mission-critical infrastructure equipment for radar, border protection and communication systems. Full power distribution and integrated ECU options are available.

Customizable upon customers request.

## KEY FEATURES

- EMI shielded 60dB, 150KHz – 10Ghz
- Light weight composite construction – no steel corrosion maintenance
- Wall mounted ECU option available
- Standard Steel ISO container construction options available

Measurements	
Internal Dimensions	196.13" x 82.64" x 89.65" 498.2 x 210 x 227.7 cm
External Shipping	238.5" x 96" x 96" 605.8 x 243.8 x 243.8 cm

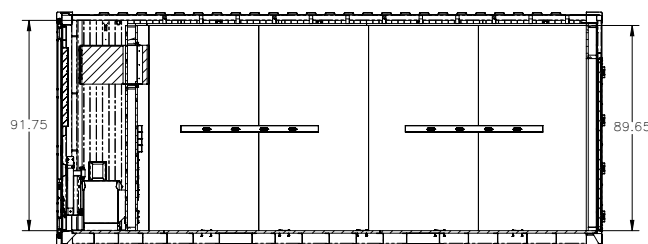
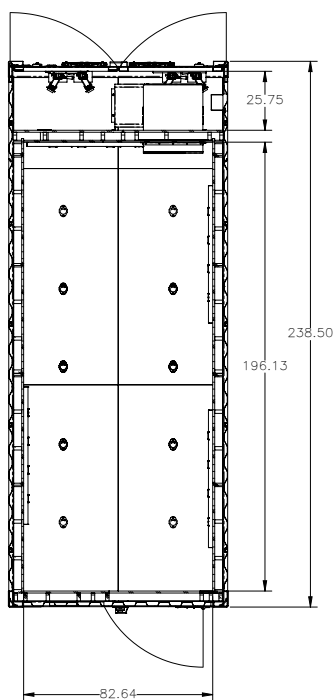





# ICEBERG

The IceBERG Containerized Ice Making System from HDT is a BICON-style, expeditionary ice plant that makes 1,800 lbs. of ice per day in temperatures from 40 to 100 degrees F. Built to operate in extreme environments, the IceBERG features an EasyTouch® display that allows the user to program ice production based on volume or time of day.

Measurements	
Internal Dimensions	
Width	10' / 304.8 cm
Length	8' / 243.8 cm
Height	8' / 243.8 cm

## KEY FEATURES

- 3376 – 3660 lbs per day production/ storage of up to 1764 lbs
- Acoustical sensing probe monitors ice thickness and consistency
- Distribution tube, curtain, water probe, water pump and water trough can be removed for thorough cleaning
- Some of the components are made with AlphaSan® antimicrobial protection
- Digital interface and programmable ice production
- Feedback interface for preventative maintenance
- Aluminum bar-grating floor with water drainage
- Operating conditions:
  - Ambient air between 40-110 degrees F
  - Incoming water between 40-90 degrees F
- 120/208 60A service with Amphenol connectors, daisy chain capable, with grounding rod
- 120v 20a GFCI Duplex Convenience receptacle, exterior mounted
- Power requirements: 14.5A / 4.5KW / 208-230 V / 60HZ / 1PH
- Can connect to generator or shore power



# STANDARD FEATURES

	Color OD Green	Color Tan	Front Entry Door with Cypher Lock	23,000 BTU LG ECU with Heat and Remote, Single Phase	Power package, 120/208 3-phase 60 A Electrical Panel with Grounding Kit	Internal LED Lighting Package with Black Out	Surface-mount Electrical Raceway 5 ft Sections with 3 Duplex Outlets, 1GFCI Outlet	Surface-mount Ethernet Raceway with 2 each CAT 6 Jacks per Raceway	Side Entry Door	2 Sided Expandable
<b>E2S2- 20' EXPANDABLE SHELTER SYSTEM</b>										
<b>108-H046645</b>	-32	-31	1 ea.	1 ea.	1 ea.	1 ea.	8 ea.		1 ea.	X
<b>108-H046655</b>	-32	-31	1 ea.	1 ea.	1 ea.	1 ea.	8 ea.	8 ea.	2 ea.	X
<b>108-H044872 (1.5 sidewall doors)</b>	-32	-31	1 ea.	1 ea.	1 ea.	1 ea.	8 ea.			
<b>BMIEXP-11419 (vehicle/trailer mountable)</b>	-32	-31	1 ea.	1 ea.	1 ea.	1 ea.	6 ea.	12 ea.	1 ea.	X
<b>108-H042003 (vehicle/trailer mountable)</b>	-32	-31	1 ea.	1 ea.	1 ea.	1 ea.	8 ea.	21 ea.	2 ea.	X
<b>RSPOND-11513 (100A service)</b>	-32	-31	1 ea.	1 ea.		1 ea.	8 ea.	8 ea.	1 ea.	X
<b>RSPOND-11515</b>	-32	-31	1 ea.	1 ea.	1 ea.	1 ea.	8 ea.	8 ea.	1 ea.	X
<b>E2S2 10' EXPANDABLE SHELTER SYSTEM</b>										
<b>BMIEXP-11420 (vehicle/trailer mountable)</b>	-32	-31	1 ea.	1 ea.	1 ea.	1 ea.	4 ea.	8 ea.	1 ea.	X
<b>RSPOND-11046</b>	-32	-31	1 ea.	1 ea.	1 ea.	1 ea.	4 ea.	4 ea.		X
<b>108-H045501 (vehicle/trailer mountable)</b>	-32	-31	1 ea.	1 ea.	1 ea.	1 ea.	5 ea.	15 ea.		X
<b>108-H046637</b>	-32	-31	1 ea.	1 ea.	1 ea.	1 ea.	6 ea.		1 ea.	X
<b>LP2 SINGLE PALLET POSITION EXPANDABLE SHELTER</b>										
<b>E2S2LP-11496</b>	-32	-31	1 ea.	1 ea.	1 ea.	1 ea.	4 ea.	4 ea.		X
<b>RSPOND-11509</b>	-32	-31	1 ea.	1 ea.	1 ea.	1 ea.	6 ea.			X
<b>E2S2LP-11497</b>	-32	-31	1 ea.	1 ea.	1 ea.	1 ea.	6 ea.	6 ea.		X
<b>JLTS BASE SHELTER (FDC/C2 MODEL)</b>										
<b>108-H043676</b>	-32	-31								
<b>JLTS NON-EMI SHELTER (S-6 MODEL)</b>										
<b>108-H049543</b>	-32	-31								



Power Support Cable, 60A 50ft	Air Flow Kit, Passive Air Vents on Rear Wing Walls and Front Wall Exhaust Fan	Data Pass Thru Ports	Safety Kit, CO / Smoke Detector, Emergency Lighting and Fire Extinguisher	Manual Leveling Jacks	Cargo Tie Kit, Stainless Steel D-rings, Floor-mounted	Power Package, 120/208 3-phase 100 A Electrical Panel with Grounding Kit	Generator, Kubota Engine 1800 RPM Tier IV Compliant, NPE32-C/4, 12.8 kW 4 Pole 12 Wire, 3 Phase	Power Support Cable, 100A 50 ft with Amphenol Connector	Stowable External-mounted Staircase and Platform	External ECU Ducts	1.5 Sidewall Door with Ramp Access	Furniture Package: 48" Bush Business Desk and Mesh Task Chair	Tare Weight
1 ea.	1 ea.	2 ea.	1 ea.	4 ea.	10 ea.								8,500 lbs.
1 ea.	1 ea.	2 ea.	1 ea.	4 ea.	10 ea.		1 ea.						9,500 lbs.
1 ea.	1 ea.	2 ea.	1 ea.	4 ea.	10 ea.						2 ea.		8,500 lbs.
1 ea.	1 ea.	2 ea.	1 ea.	4 ea.	10 ea.				1 ea.	2 ea.			8,500 lbs.
	1 ea.	2 ea.	1 ea.	4 ea.	10 ea.		1 ea.		1 ea.	2 ea.			9,500 lbs.
	1 ea.	2 ea.	1 ea.	4 ea.	10 ea.	1 ea.		1 ea.				4 ea.	8,700 lbs.
1 ea.	1 ea.	2 ea.	1 ea.	4 ea.	10 ea.								
1 ea.	1 ea.	2 ea.	1 ea.	4 ea.	4 ea.				1 ea.	2 ea.			6,000 lbs
1 ea.	1 ea.	4 ea.	1 ea.	4 ea.	4 ea.								6,000 lbs
1 ea.	1 ea.	4 ea.	1 ea.	4 ea.	6 ea.		1 ea.		1 ea.				6,000 lbs
1 ea.	1 ea.	2 ea.	1 ea.	4 ea.	4 ea.								6,000 lbs
1 ea.	1 ea.	1 ea.	1 ea.	4 ea.	4 ea.								4,500 lbs.
1 ea.	1 ea.		1 ea.	4 ea.									4,500 lbs.
	1 ea.	2 ea.	1 ea.	4 ea.	4 ea.								4,500 lbs.



# E2S2 SPECIALTY CONFIGURATIONS

## LATRINE CONFIGURATION

ETS (Expeditionary TRICON System), All Latrine P/N RSPOND-11253

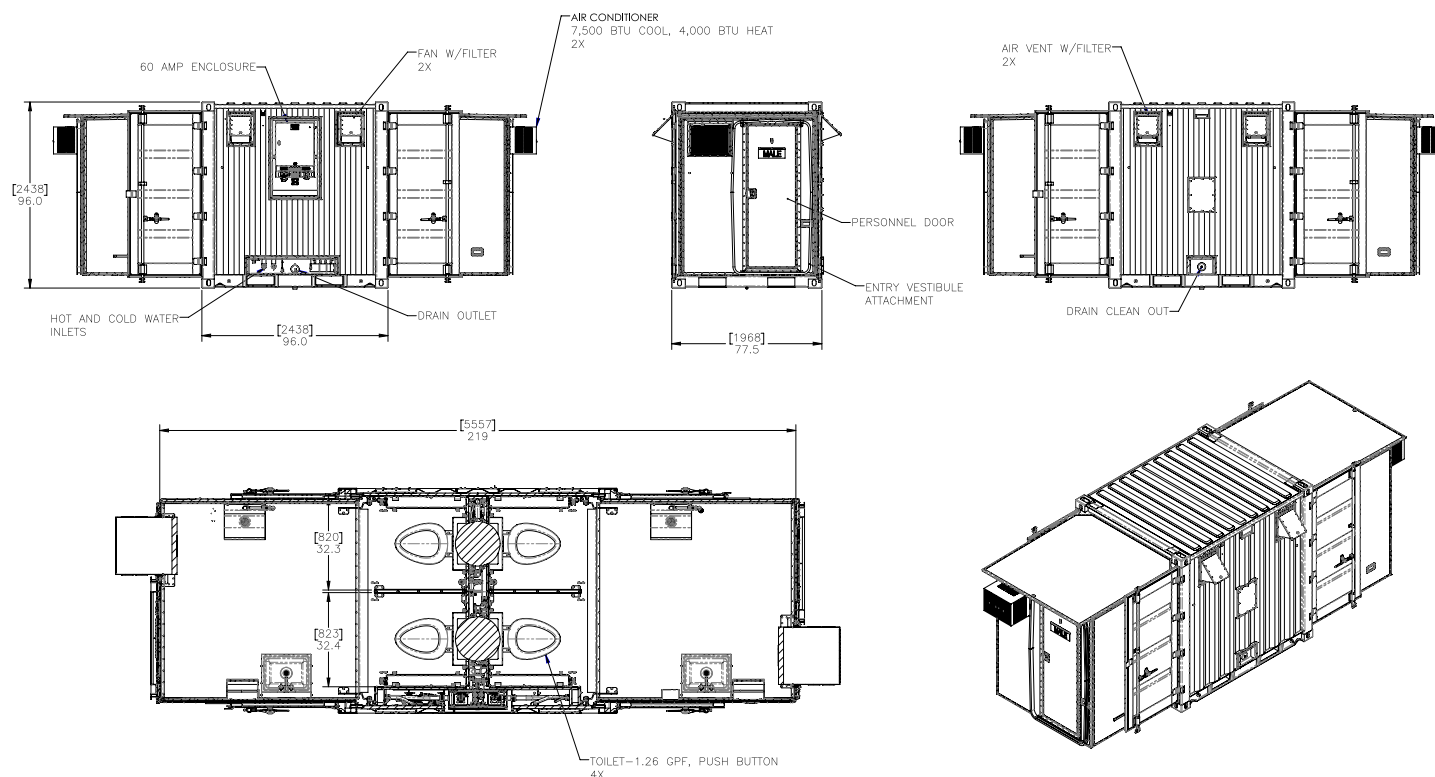

## SHOWER CONFIGURATION

ETS (Expeditionary TRICON System), All Shower P/N RSPOND-11254

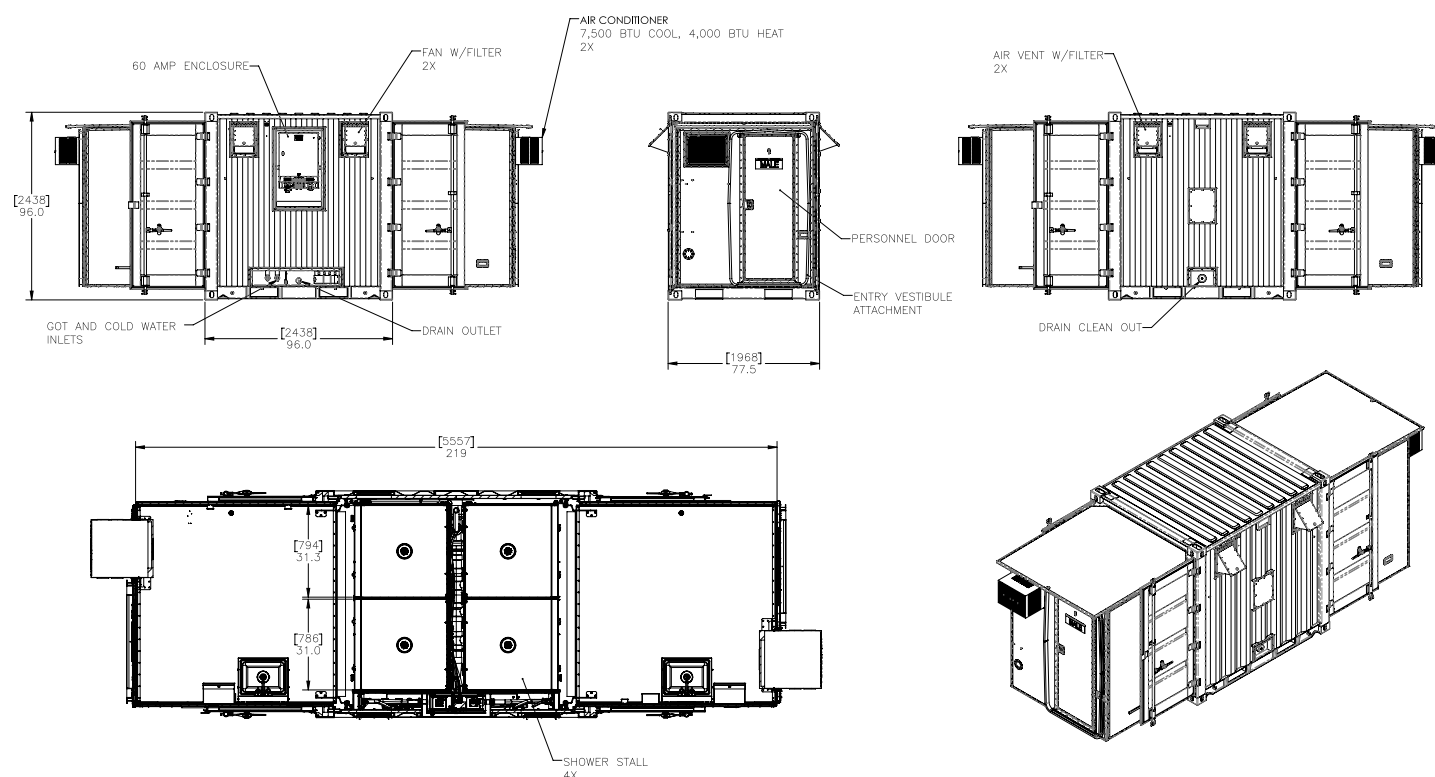



## HYGIENE CENTER CONFIGURATION

20' Expandable Hygiene Center P/N RSPOND-11210

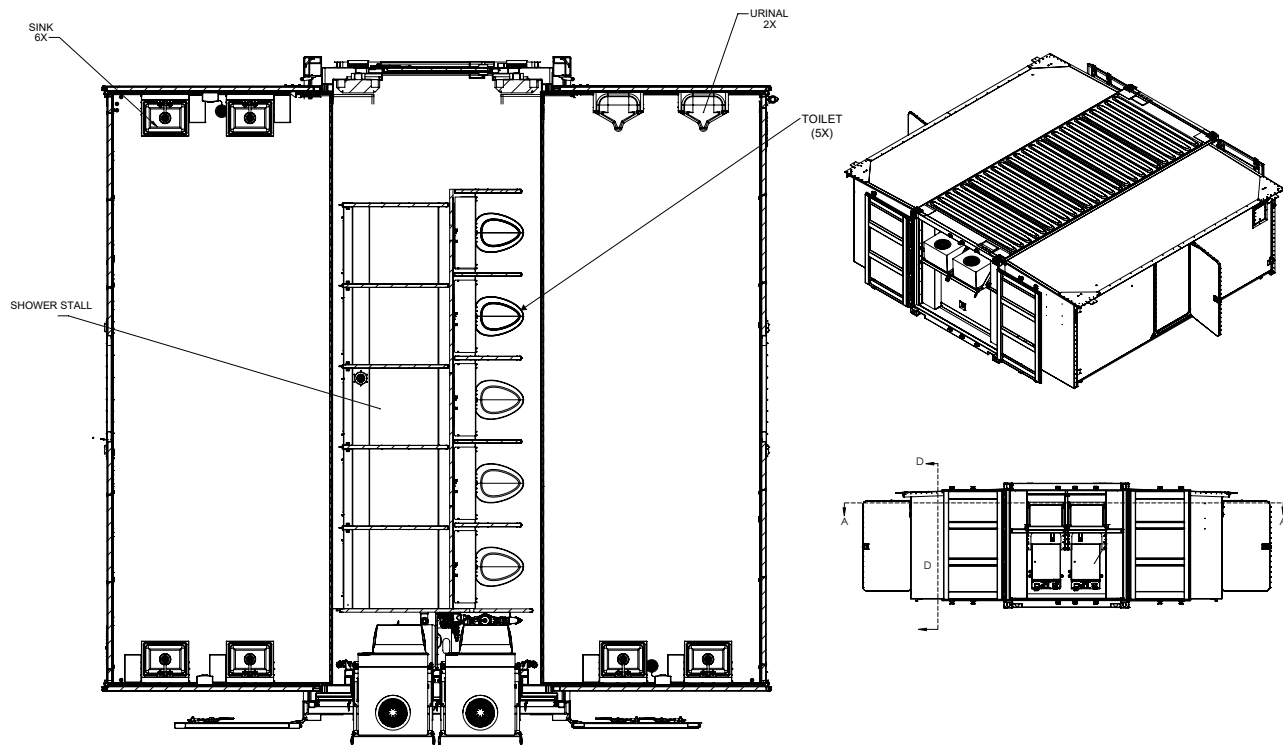

## LAUNDRY CONFIGURATION

20' Expandable, All Laundry P/N RSPOND-11170

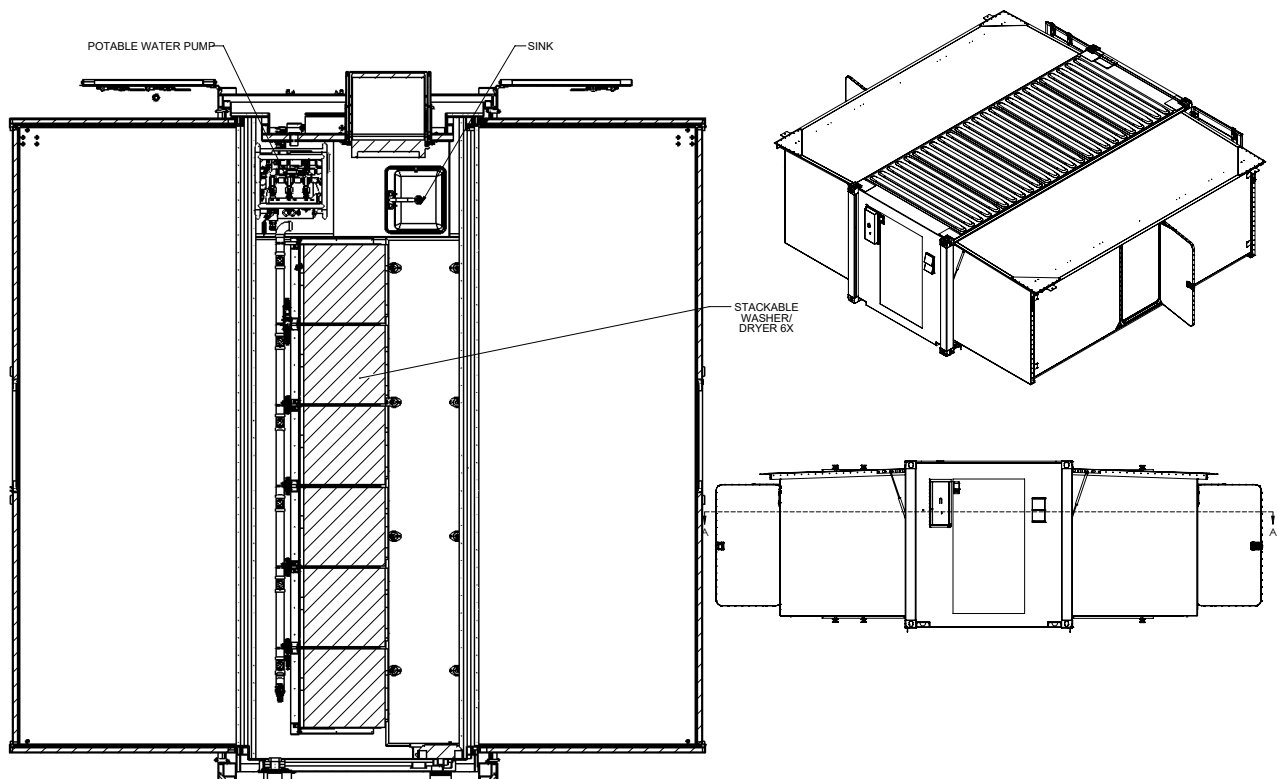

# E2S2 SPECIALTY CONFIGURATIONS

## KITCHEN CONFIGURATION

20' Expandable, All Electric Kitchen P/N RSPOND-11111

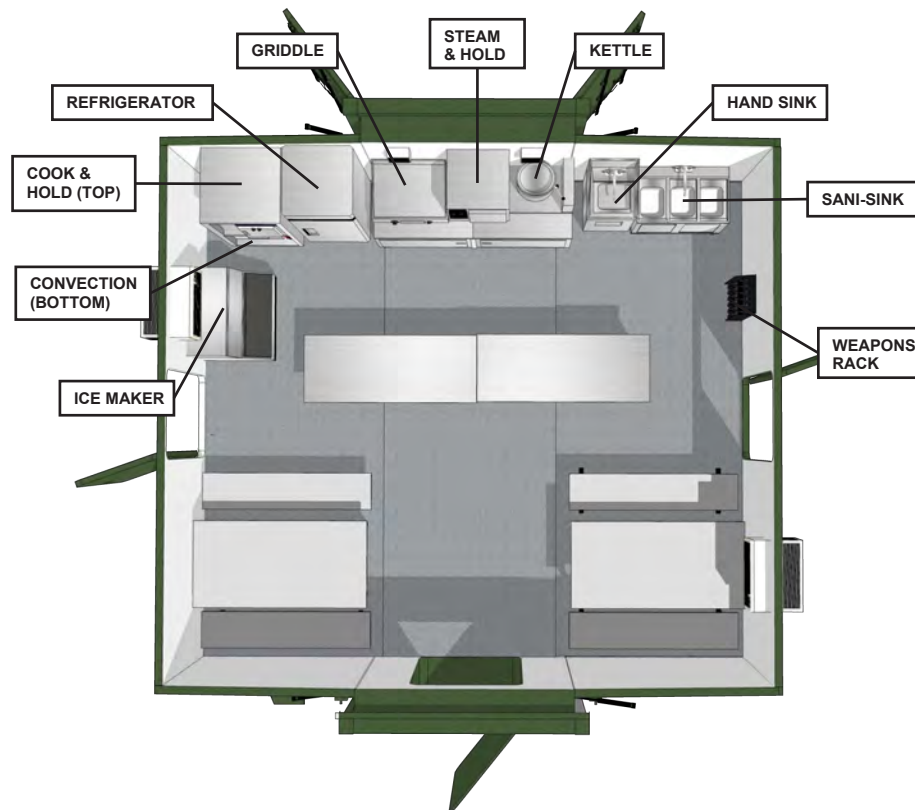









**HDT Expeditionary Systems, Inc.**

30500 Aurora Road

Suite 100

Solon, OH 44139

800.969.8527

[www.hdtglobal.com](http://www.hdtglobal.com)

Rev 03 11/2024